



TENT OWNERS MANUAL

FAST FRAME CABIN 6 PERSON

BEFORE YOU BEGIN

This tent requires a minimum of two people to set up
Read all the instructions before setting up your tent.
Check parts list to ensure you have full contents
Find a Flat area for your tent, free from rocks, potholes and branches
Ensure that you use all pegs, ropes and additional poles only as instructed
If conditions are windy, arrange tent as to have narrowest side of tent facing into the wind
Keep away from Open Flames, DO NOT USE Stoves or Burning Appliances inside the tent

WARNING

AVOID CONTACT WITH OPEN FLAMES:

This tent is manufactured to meet CPAI-84 Fire Retardant standards. The fabric may burn if in continuous contact with open flame sources.

CONDENSATION IS NOT LEAKING:

Minimise condensation by ensuring your tent is well ventilated through windows, doors or vents.



STITCH LINE

CONTENTS

Inner Tent x 1
Rain Fly x 1
DuraPlus Rain Fly Vestibule Pole x 1
Steel Portico Poles x 2
Steel Awning Poles x 2
Pegs x 31
Guy Ropes x 14

DuraPlus Vestibule Pole x 1:



Steel Awning Pole x 2:



Steel Portico Pole x 2:



STORAGE

To maximise the life of your tent, always ensure it is clean of dirt and debris.
Never store if wet or damp. Consider airing your tent at home after your trip and allow to completely dry before storing between trips
Continued exposure to sunlight can degrade the polyesters used to make tents. Always store your tent in its storage bag, away from direct light in a cool, dry space

SPARE PARTS AND ASSISTANCE - For details see www.oztrail.com.au

WARRANTY - For details see www.oztrail.com.au/warranty

OZtrail® is a registered trademark of
Adventure Trading Australia Pty Ltd

Designed & Imported by:
Adventure Trading Australia Pty Ltd
71 Charles Ulm Place,
Eagle Farm, QLD 4009
AUSTRALIA



Made in Bangladesh

SEE OTHER SIDE FOR PITCHING INSTRUCTIONS



TENT OWNERS MANUAL

FAST FRAME CABIN 6 PERSON

STEP 1: LAYOUT THE INNER TENT

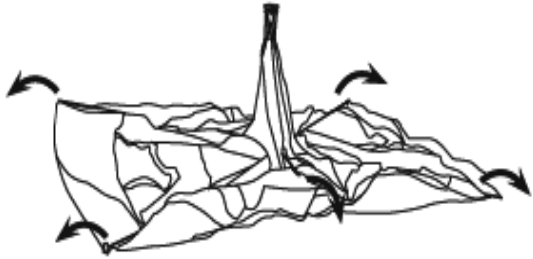

Unfold the inner tent and outstretch over a flat, clear area
 Arrange the door so it is facing your desired area for entry & exit
 Fold leg poles away from the center of the tent, so the roof framing stands up

STEP 2: ERECT THE INNER TENT FRAME

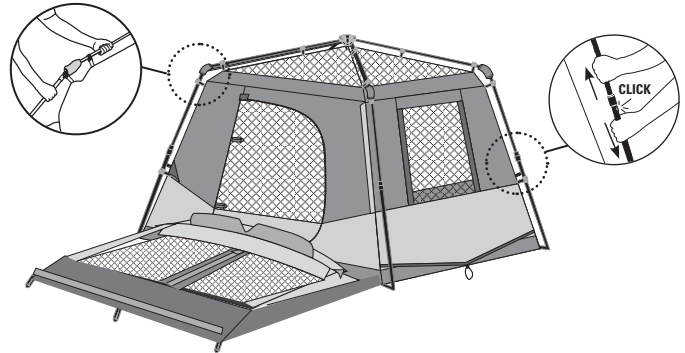

Locate roof poles and lift upwards from base, to the horizontal position.
 The leg poles will angle at joints and partially stand up

STEP 3: SET UP VESTIBULE

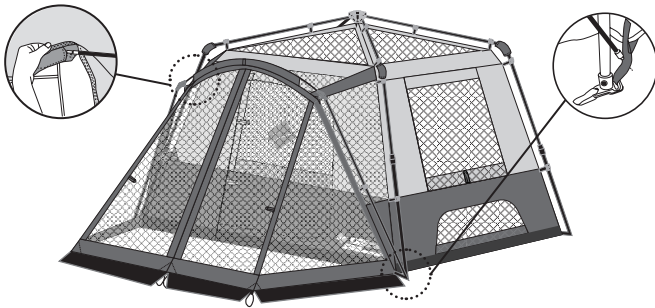

Place Vestibule pole through sleeve located at the front of the inner tent
 Insert Vestibule pole into black plastic molding
 Insert Steel Portico Pole into opposite side of black molding
 Connect base of Portico Pole to ring and pin on Grey Webbing stitched to Inner tent corner
 Attach plastic clips to tent poles on vestibule

STEP 4: PUT ON FLY AND SECURE TO INNER TENT

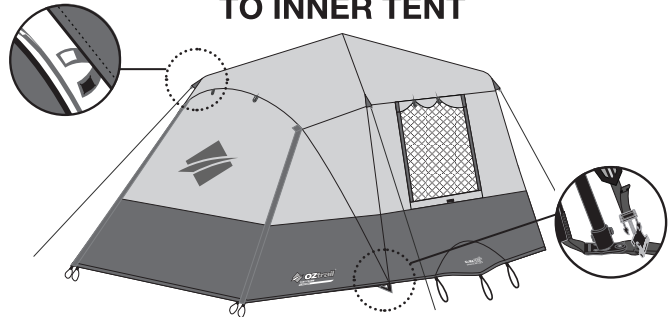

Place rain fly over the inner tent with vestibule facing the front
 Secure rain fly to tent with Velcro tabs located on underside of rain fly
 Connect the fly to the tent using the buckles on tent corners

STEP 5: ASSEMBLE THE AWNINGS



Use the awning poles and additional ropes to suspend the door panel overhead
 Peg out the tent and fly around the perimeter

STEP 6: ALWAYS PEG OUT AND USE GUY ROPES



In windy and rainy conditions, awnings must be dismantled, and doors must be closed, and guy ropes must be set out

PACK UP:

TO TAKE DOWN THE TENT, REVERSE THE PREVIOUS STEPS