



PORTABLE BUTANE STOVE with or without hotplate

OPERATING INSTRUCTIONS



CM2230SP

WARNING: FOR OUTDOOR USE ONLY



- Improper installation, adjustment, alteration, service or maintenance can cause property damage, injury or death. DO NOT modify this appliance.
- WARNING: Accessible parts may be very hot. Keep young children away at all times.
- Do not move the appliance during use.
- Important. Read these instructions for use carefully.
- Familiarise yourself with the appliance before connecting it to its gas cartridge. Keep these instructions for future reference. ONLY USE IN WELL-VENTILATED AREAS

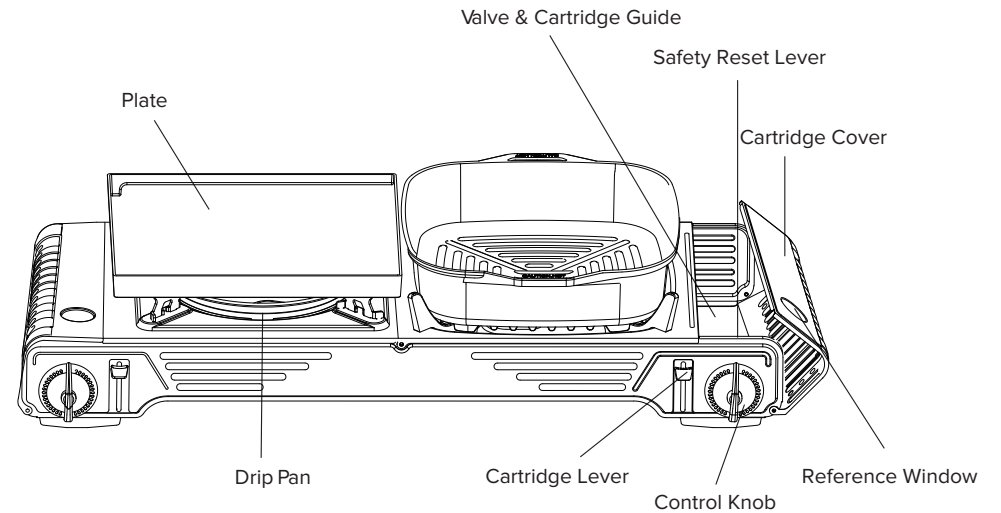

Before first use, remove all packaging from the stove and read these instructions completely.

OPERATING INSTRUCTIONS

Each burner requires an individual cartridge to operate. The left hand burner operates from a cartridge situated in the left hand cartridge bay and the right hand burner operates from a cartridge situated in the right hand cartridge bay. The following instructions are written for an individual side as this can be used independently. The operator is to ensure that the instructions are correctly applied to each side of the appliance.

HOW TO INSTALL A GAS CARTRIDGE

1. Turn the control knob to the OFF position. Make sure that the cartridge lever is in the UNLOCK position. If the gas knob is in the ON position the cartridge cannot be put into position.
2. Open the cartridge cover and insert the gas cartridge. Make sure that the cartridge slot fits into the cartridge lever guide on the valve inside the stove.
(Caution: Use only approved butane gas cartridge UL147B or EN417)

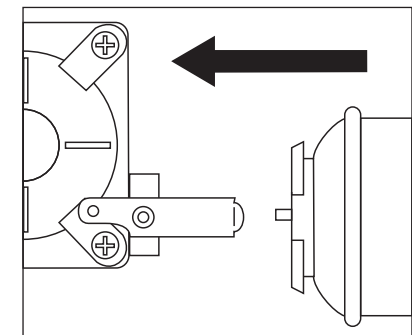
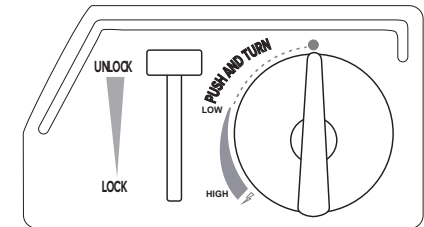

- When you are ready to use the stove, push the cartridge lever down to the FUEL-LOCK position. If a hissing sound or gas smell is evident, check that cartridge is fitted correctly. Repeat step 2 to stop the gas leakage. If lever is hard to push down, do not force it. Check that the cartridge is fitted correctly and the control is in the OFF position.

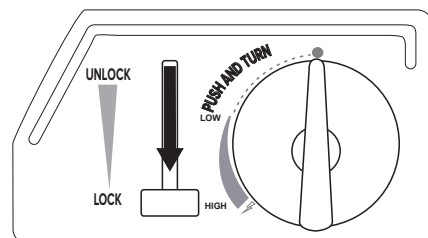

IGNITION:

- Push the control knob in and turn the control knob towards the IGNITION position until a click is heard from the piezo ignitor.
- If ignition fails, turn the control knob back to the OFF position and repeat.

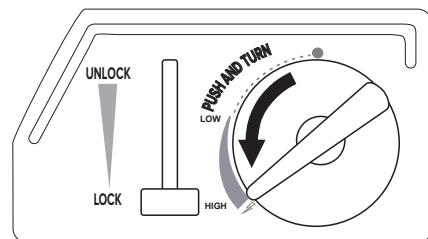

HEAT CONTROL:

The control knob can be turned to adjust the flame output. Adjust it to the suitable position for cooking.

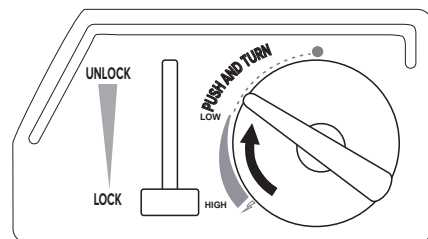

EXTINGUISHING:

- Turn the control knob to the OFF position. Confirm that the flame is completely extinguished.
- Raise the cartridge lever to the UNLOCK position, and take out the gas cartridge when the stove is not in use.

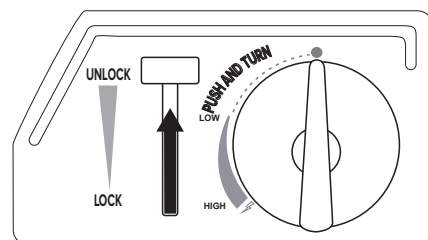
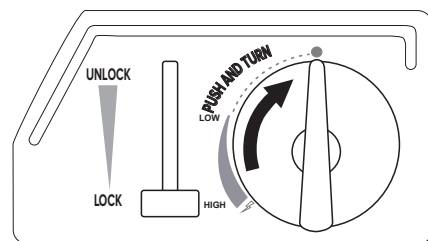

WARNING!!

- Do not store cartridge in stove during transportation or storage.
- Replace the nozzle cap back onto the cartridge to protect nozzle and avoid accidental gas leakage if nozzle is bumped or depressed.
- Avoid boil overs and spillage.
- During use parts may become very hot. Keep young children away.
- Allow to cool before moving or handling.
- Do not use as a space heater.
- Do not use for any purpose other than cooking.
- Do not operate stove in the carry case.
- Caution: Never obstruct the air openings or vents on this appliance.

HOW TO RESET THE SAFETY SHUT OFF

If the stove is used in a hot area such as outdoors in direct sunlight or incorrectly the cartridge will become hot and the pressure inside the cartridge will increase. If the pressure approaches a dangerous level the safety device will activate by ejecting the cartridge. If the ejection mechanism fails, this stove features a secondary safety shut off which can be reset by pushing the lever. If either of these safety devices activate, your method of use is causing the cartridge to overheat. Be responsible and only use this stove safely, as described in these instructions.

It may be necessary to open the control knob to release the pressure before another canister can be installed into the stove.

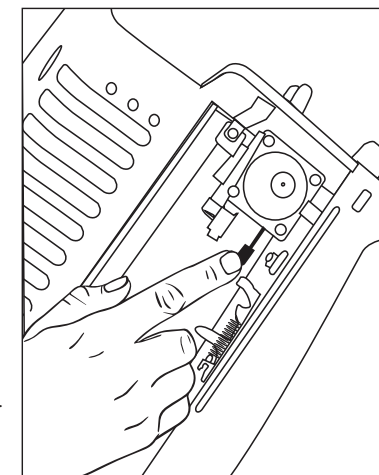

PRECAUTIONS

GAS CARTRIDGE:

- This appliance shall only be used with a butane cartridge certified to UL147B or EN417. IT MAY BE HAZARDOUS TO ATTEMPT TO FIT OTHER TYPES OF GAS CARTRIDGES.
- The cartridge should be placed away from flammable products or direct sunlight. Never keep cartridge in places where the temperature is over 50°C.
- Do not subject the cartridge to impact or rough handling.
- Cartridges must be stored outdoors in a well ventilated location out of reach of children.
- Do not puncture or incinerate empty cartridge.
- Avoid carrying cartridge in the boot of a car or any unventilated enclosure.
- Gas cartridges shall be changed in a well ventilated location, preferably outside, away from people and any sources of ignition such as naked flames, electric heaters/equipment.
- To check if gas cartridge contains gas, disconnect from the stove, then hold upright and shake from side to side. If you can feel or hear liquid movement, it contains gas.

STOVE:

- Check the seals between the appliance and the gas cartridge are in place and in good condition before connecting the gas cartridge.
- Do not use this appliance if it has damaged or worn seals.
- Do not use this appliance if it is leaking, damaged or does not operate properly.
- Do not try to detect leaks using a flame.
- This appliance must only be serviced by an authorised person.
- Do not modify this appliance.

USE:

1. Do not use for any purpose other than cooking. Incorrect use may result in overheating, incomplete combustion and/or a risk of fire or explosion.
2. **DO NOT USE THIS STOVE TO LIGHT** briquettes or heat beads.
3. In the event of a gas leak (smell of gas) immediately turn the control to the off position and move the cartridge lever to the unlock position to isolate the gas supply.
4. Do not move the appliance during operation.
5. The maximum sized vessel (pot or pan) to be used on the stove is 26.5cm diameter. Unless your model includes a specific cooking plate or cooking pot/pan

Cooking with the non-stick hotplate and deep dish cooking pan

1. Wash the cooking plate and pan before the first use.
2. The hotplate and pan reaches cooking temperature very quickly. To prevent damage to your cooking plate, do not preheat the plate or pan for an excessive period.
3. Take care when cooking to avoid scratching the cooking surfaces with utensils.
4. Prevent fat fires. Never allow the fat/grease channel to overflow.
5. When you are finished cooking, turn off the burners and allow the hotplate and pan to cool down before packing away. Do not splash the hotplate suddenly with water while hot, this may cause the hotplate to warp.
6. To fix a warped hotplate, place it back on the stove with both burners on high for 30 seconds before the plate is allowed to cool. It may return back to the original shape.
7. After each use, clean food residue from the cooking plate with a non-scratch type sponge to prevent corrosive damage to the cooking surface.

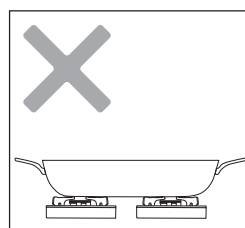
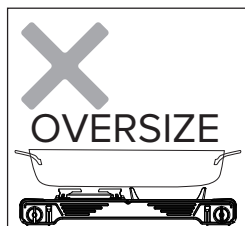
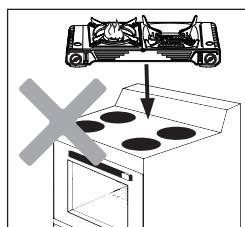
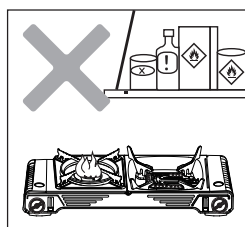
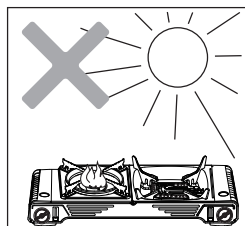
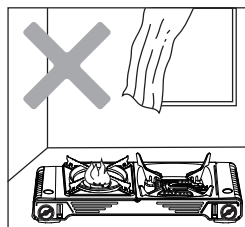

PLACEMENT:

1. Do not use the stove in very windy conditions.
2. Do not place or use this appliance on any hot surface.
3. Do not use the stove under overhanging shelves etc.
4. Do not use close to combustible materials such as curtains. No combustible materials should be within 400mm from any side of the stove and 1200mm above.
5. Use stove in the shade or in cool places. Avoid using in direct sunlight.
6. Only operate this appliance on a flat horizontal surface and ensure the aeration opening below the stove is clear and unobstructed.
7. **CARBON MONOXIDE HAZARD- USING THIS APPLIANCE IN AN ENCLOSED SPACE MAY CAUSE DEATH. DO NOT USE IN CARAVANS, TENTS, MARINE CRAFT, CARS, MOBILE HOMES OR SIMILAR LOCATIONS.**

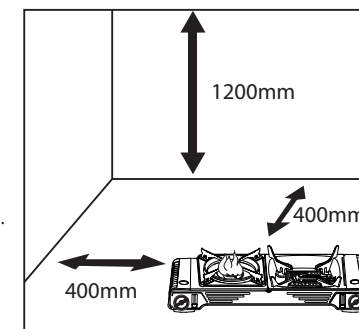

ABNORMAL OPERATION

Abnormal operation can be identified by:

- Frequent activation of pressure safety device
- Jamming of cartridge lock lever
- Irregular burner flame which is yellow or unstable
- Black sooting of cooking utensils

Refer to the trouble shooting section of this manual for possible solutions. If the stove does not operate properly **DO NOT** use the appliance.

MAINTENANCE

PRECAUTIONS:

1. Make sure that the gas cartridge is released before cleaning.
2. Never remove safety devices or gas components.

CLEANING:

1. Body: Wipe off with a clean cloth. When necessary, use a kitchen cleanser and then finish with a dry cloth.
2. Pan support and drip pan: After washing, wipe with a dry cloth.
3. Burner: Clean the burner top and the burner ports with a hard brush making sure that all food particles are removed from the burner ports.

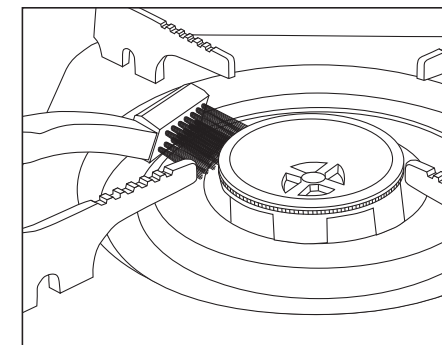

TROUBLE SHOOTING

PROBLEM CAUSE	No ignition	No burning	Unstable flame	Uneven flame	Slow burning	Gas smell	Flame extinguishes during use	SOLUTION
	Lack of fuel	●	●			●		
Spark point dirty	●							Carefully remove dirt
Dirty burner	●	●	●	●	●			Clean the burner
Imperfect cartridge alignment	●	●	●		●	●		Realign cartridge
Use of unsuitable fuel	●	●	●	●	●			Replace with cartridge containing correct fuel
Internal gas pressure too high							●	Cool down gas cartridge
Functioning of safety stop mechanism	●						●	Check and reset mechanism
Improper setting of spark point	●							Set spark point to 2mm away from burner

If you are still experiencing difficulty with the appliance after trying the above solutions, the appliance should not be used until it has been inspected and repaired by a suitably qualified person.

SPECIFICATIONS

Model No.	CM2230SP
Ignition Method	Piezo-Electric
Dimensions	678mm (W) x 285mm (D) x 128mm (H)
Weight	3.3kg
Safety Device	1. Canister ejection 2. Gas shut off
Fuel Consumption	Hob = 165g/h Pot = 125g/h Total = 290g/h
Gas Type	Butane (2 Cartridges)
Injector Size	Hob = 0.60mm Pot = 0.52mm
AGA Approved No.	8630 G



1 YEAR EXPRESS WARRANTY

Amalgamated Hardware Merchants Limited (“AHM”) warrants that this product will be free from material defects in workmanship and materials for a period of 1 year from the date of purchase (“Warranty Period”). If a material defect occurs during the Warranty Period, and AHM verifies such material defect and your claim, AHM will choose to either repair the product, replace the product, or provide you with a refund of the purchase price of the product (“AHM’s Express Warranty”). Any repaired or replaced product will be covered by AHM’s Express Warranty for the remainder of the original Warranty Period only.

AHM’s Express Warranty will not apply if the defect in the product is caused or contributed to by misuse of the product, failure to maintain the product, neglect or accident, ordinary wear and tear (including rust, corrosion, and normal fading, weathering, staining, discolouration, scratching or chipping), exposure to heat, failure to use or install the product in accordance with any instructions or manuals, or any modification, repair or tampering with the product by anyone other than AHM.

To claim under AHM’s Express Warranty, you must take the product (and proof of purchase) to the store where it was purchased. You must provide any additional information requested in relation to your claim. For online purchases, contact the online supplier to arrange the return of the product. You will bear any costs incurred in making a claim, including any costs of returning the product to the store, and of having the product returned to you (if applicable).

ADDITIONAL GUARANTEES UNDER CONSUMER LAWS

The New Zealand Consumer Guarantees Act 1993 and the Australian Competition and Consumer Act 2010 (including the Australian Consumer Law 2011), as well as other laws in those jurisdictions (“Consumer Law”) give you other legal rights. For products sold in New Zealand, these rights cannot be modified or excluded by any contract, except in those circumstances expressly contemplated by New Zealand Consumer Law. For products sold in Australia, our goods come with guarantees that cannot be excluded under the Australian Consumer Law. You are entitled to a replacement or refund for a major failure and for compensation for any other reasonably foreseeable loss or damage. You are also entitled to have the goods repaired or replaced if the goods fail to be of acceptable quality and the failure does not amount to a major failure. AHM’s Express Warranty is in addition to any other rights and remedies you have under the applicable Consumer Law. Except as otherwise provided by AHM’s Express Warranty, all warranties, terms, conditions, guarantees or similar, other than those which cannot be excluded under applicable Consumer Law, are expressly excluded by AHM to the extent legally permitted.

AHM NZ

8 Hautu Drive, Wiri, Auckland, New Zealand 2104
 Phone: + 64 9 251 1300
 Email: enquiries@ahm.co.nz
 Fax: + 64 9 251 1301
 www.ahm.co.nz

AHM AUS

1/169 Given Terrace Paddington Queensland 4064
 Phone: + 61 7 336 8419
 Email: enquiries@ahmaustralia.com.au