



weber® 
Cart

58415
01/08/14

Failure to follow the DANGERS, WARNINGS and CAUTIONS contained in this Owner's Guide may result in serious bodily injury or death, or may result in a fire or an explosion causing damage to property.

DANGERS, WARNINGS and CAUTIONS:

- ⚠ For use with Q® 2000 Series barbecues ONLY
- ⚠ Never move the Weber® Q® barbecue on the Weber® Q® cart when it is in operation and/or hot.
- ⚠ For outdoor use only.
- ⚠ Genuine Weber-Stephen Replacement Parts must be used for any repair or replacement. Your actions, if you fail to follow this product warning, may cause a fire, an explosion, or structural failure resulting in serious personal injury or death as well as damage to property (Will void all warranty protection).
- ⚠ When using the Weber® Q® barbecue on the Weber® Q® cart, follow all Dangers, Warnings, and Cautions associated with the Weber® Q® barbecue.
- ⚠ Improper assembly may be dangerous. Please carefully follow the assembly instructions in this manual.
- ⚠ You should exercise reasonable care when operating your Weber® Q® cart with the Weber® Q® barbecue.
- ⚠ Setup the Weber® Q® cart on an outdoor stable level surface before placing the Weber® Q® barbecue on the cart.
- ⚠ Never setup the Weber® Q® cart on a sloping surface.
- ⚠ The Weber® Q® cart is meant for the use of the Weber® Q® barbecue only. Do not attempt to attach any other products or appliances to the Weber® Q® cart.
- ⚠ Remove the Weber® Q® barbecue from the Weber® Q® cart before placing the Weber® Q® cart in a vehicle trunk, station wagon, mini-van, sport utility vehicle (SUV), recreational vehicle (RV), or any storage area.
- ⚠ Never use the Weber® Q® cart as a step stool or ladder.
- ⚠ Do not use the Weber® Q® cart or place the Weber® Q® barbecue on the Weber® Q® cart if any parts are missing or damaged.
- ⚠ Improper assembly of barbecue may be dangerous. Please follow the assembly instructions carefully.
- ⚠ Do not use this barbecue unless all parts are in place. The barbecue must be properly assembled according to the assembly instructions.
- ⚠ Your Weber® gas barbecue should never be used by children. Accessible parts of the barbecue may be very hot. Keep young children away while barbecue is in use.
- ⚠ Exercise caution when using your Weber® gas barbecue. It will be hot during cooking or cleaning, and should never be left unattended, or moved while in operation.
- ⚠ Do not use charcoal or lava rock in your Weber® gas barbecue.
- ⚠ While igniting the barbecue or cooking, never lean over open barbecue.
- ⚠ Never place hands or fingers on the front edge of the cookbox when the barbecue is hot or the lid is open.
- ⚠ Do not attempt to disconnect the gas regulator and hose assembly or any gas fitting while your barbecue is in operation.
- ⚠ Use heat-resistant barbecue mitts or gloves when operating barbecue.
- ⚠ Use the pressure regulator and hose assembly that is supplied with your Weber® gas barbecue.
- ⚠ Should the burners go out while barbecue is in operation, turn all gas valves off. Open the lid and wait five minutes before attempting to relight barbecue, using the igniting instructions.
- ⚠ Do not use the barbecue within 24 inches (61cm) of combustible materials. This includes the top, bottom, back or sides of the barbecue.

- ⚠ Do not build this model of barbecue in any built-in or slide-in construction. Ignoring this **WARNING** could cause a fire or an explosion that can damage property and cause serious bodily injury or death.
- ⚠ Do not store an extra (spare) or disconnected LPG cylinder under or near this barbecue.
- ⚠ After a period of storage and/or nonuse, the Weber® gas barbecue should be checked for gas leaks and burner obstructions before use. See instructions in this Owner's Guide for correct procedures.
- ⚠ Do not operate the Weber® gas barbecue if there is a gas leak present.
- ⚠ Do not use a flame to check for gas leaks.
- ⚠ Do not put a barbecue cover or anything flammable on, or in the storage area under the barbecue while barbecue is in operation or is hot.
- ⚠ Universal liquefied petroleum gas is not natural gas. The conversion or attempted use of natural gas in a universal liquefied petroleum gas unit or universal liquefied petroleum gas in a natural gas unit is dangerous and will void your warranty.
- ⚠ Keep any electrical supply cord and the fuel supply hose away from any heated surfaces.
- ⚠ Do not enlarge valve orifices or burner ports when cleaning the valves or burners.
- ⚠ The Weber® gas barbecue should be thoroughly cleaned on a regular basis.
- ⚠ A dented or rusty LPG cylinder may be hazardous and should be checked by your liquid propane supplier. Do not use a LPG cylinder with a damaged valve.
- ⚠ Although your LPG cylinder may appear to be empty, gas may still be present, and the cylinder should be transported and stored accordingly.
- ⚠ If you see, smell or hear the hiss of gas escaping from the LPG cylinder:
 1. Move away from LPG cylinder.
 2. Do not attempt to correct the problem yourself.
 3. Call your fire department.
- ⚠ Should a grease fire occur, turn off all burners and leave lid closed until fire is out.

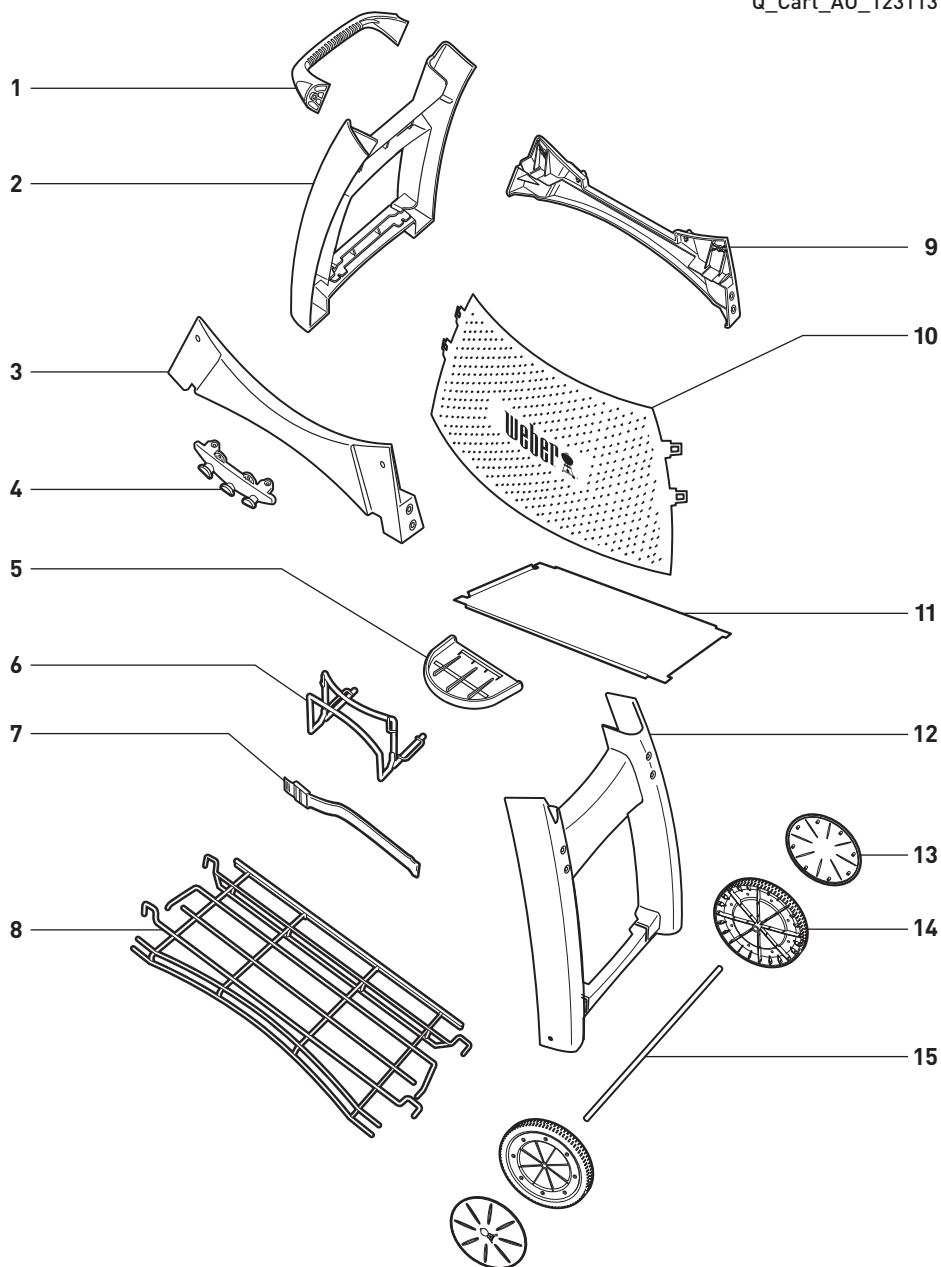

- | | | |
|----------------------|------------------------------|--------------------|
| 1) Handle | 6) Cylinder Bracket Assembly | 11) Grease Shield |
| 2) Left Cart Leg | 7) Cylinder Strap | 12) Right Cart Leg |
| 3) Front Cross Brace | 8) Bottom Rack | 13) Wheel Cover |
| 4) Tool Hook | 9) Rear Cross Brace | 14) Wheel |
| 5) Cylinder Rest | 10) Cylinder Screen | 15) Axle |

1-

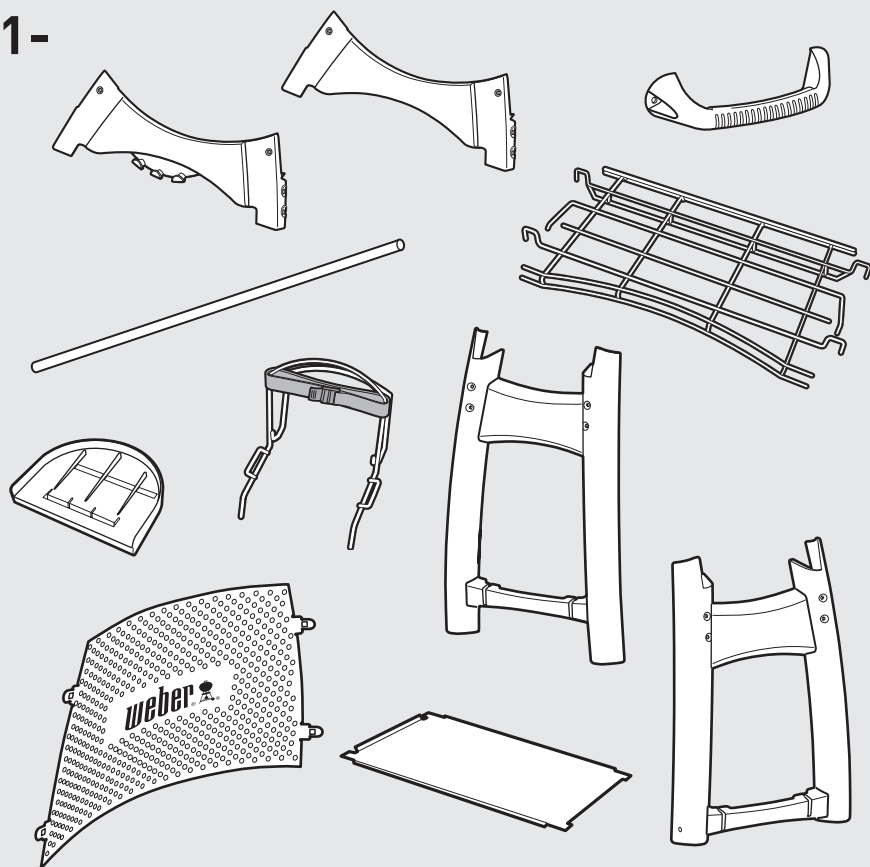

2-

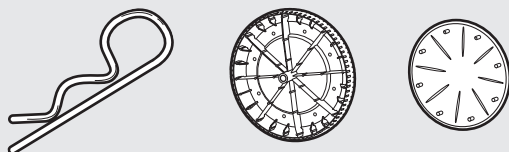

8-

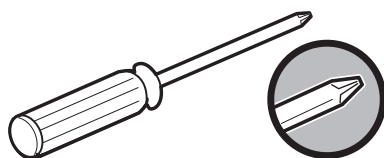

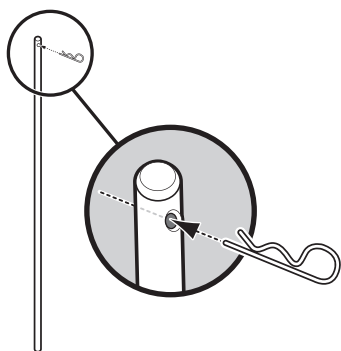
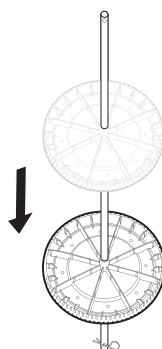
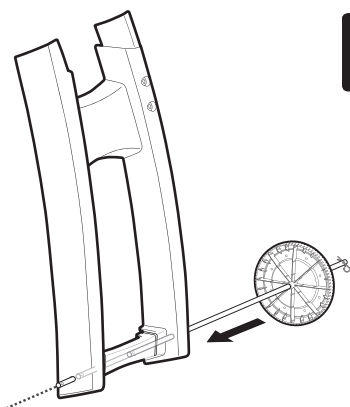
1**2****3****4**

Molded legs may be slightly warped. This does not effect assembly and is not a defect.

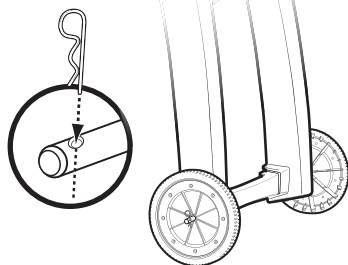
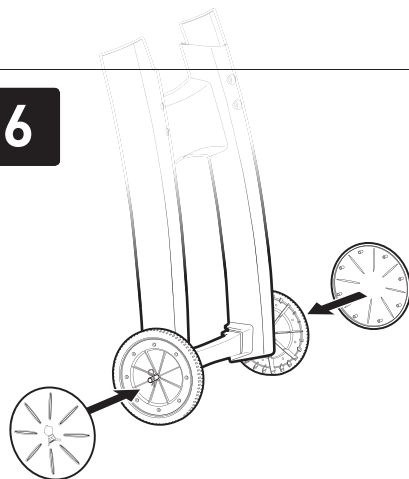
5**6**

7

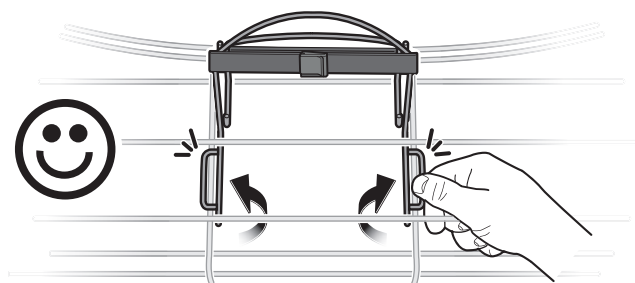
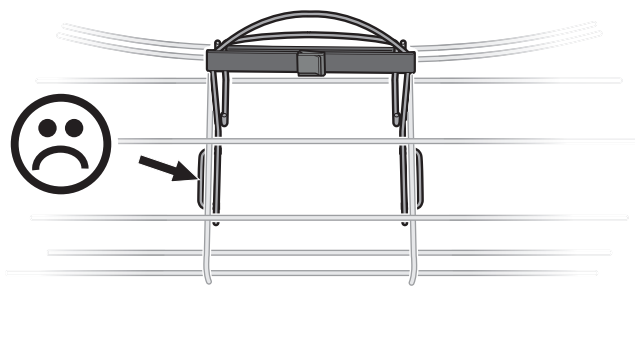
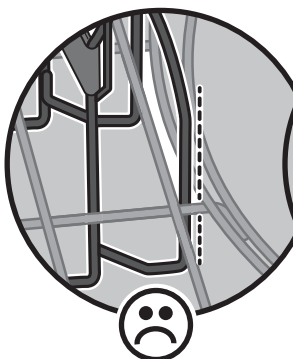
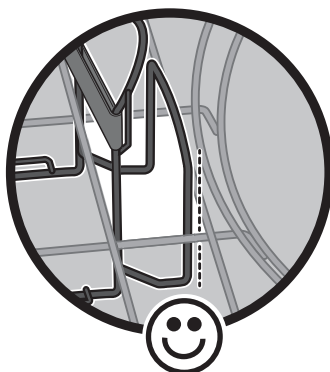
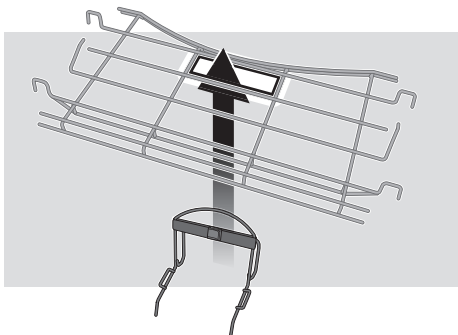

8

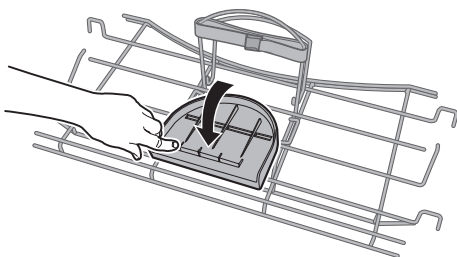
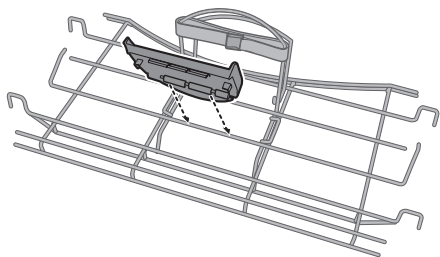
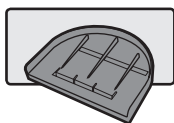

9

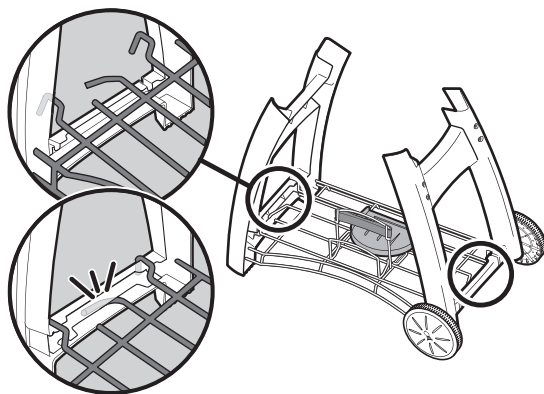
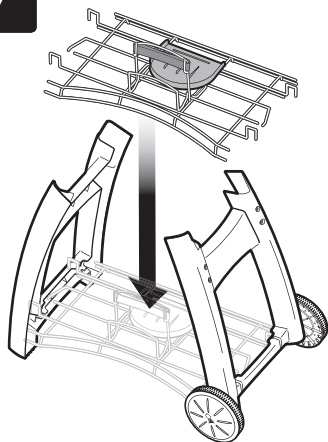

10

2-

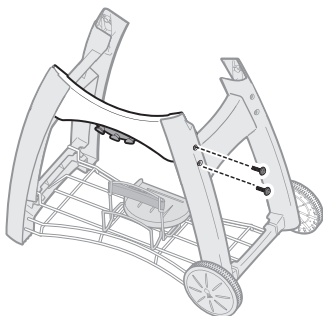
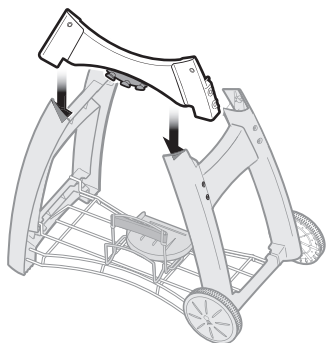

11

2-

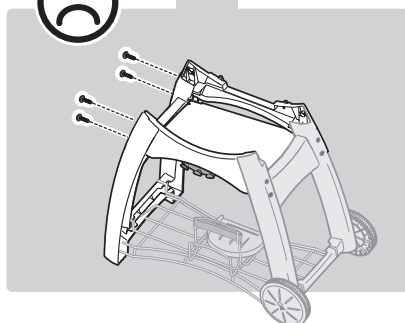
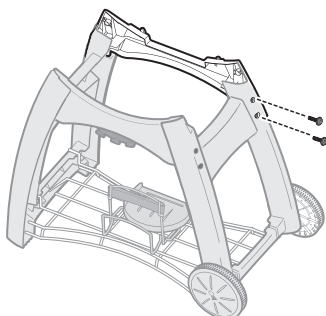
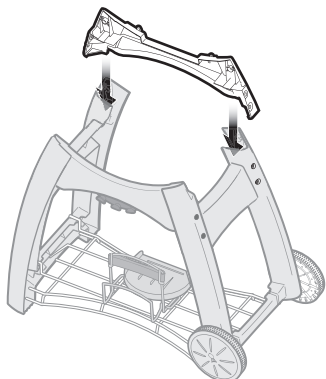

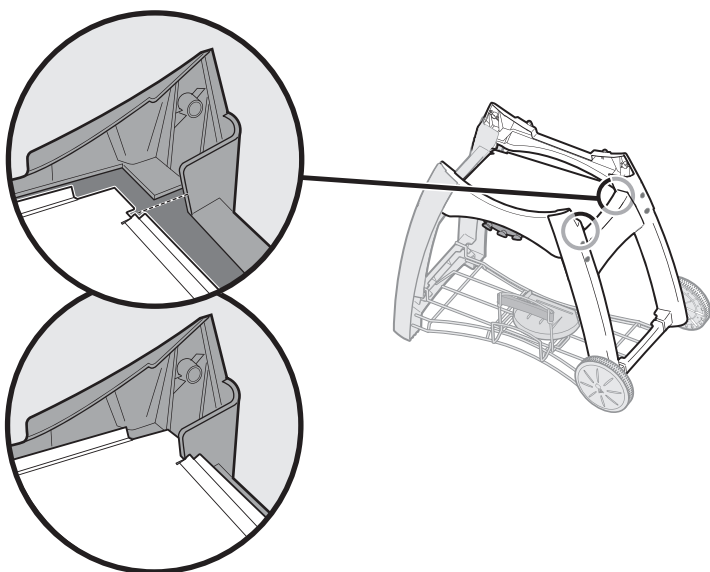
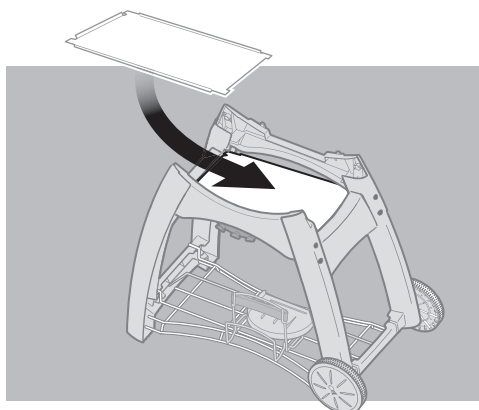

13

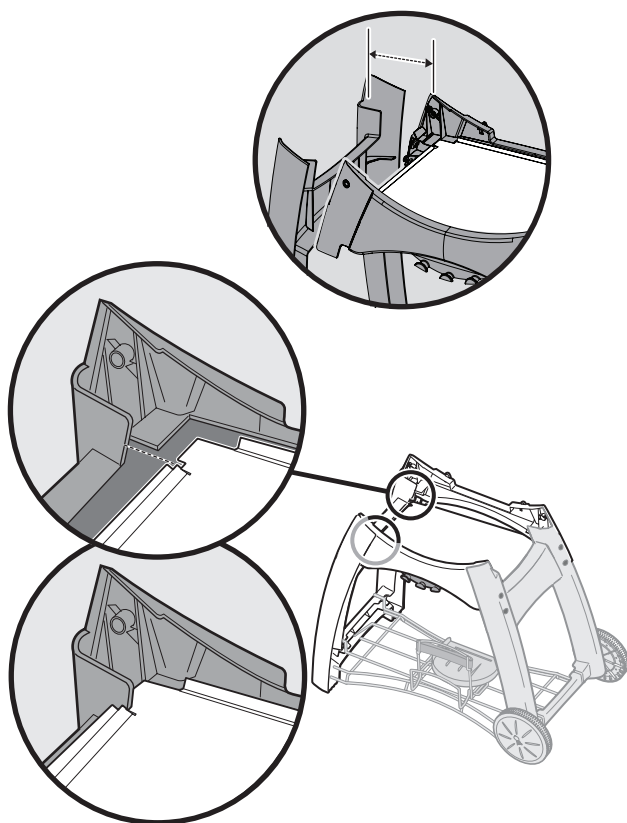

14

4- 

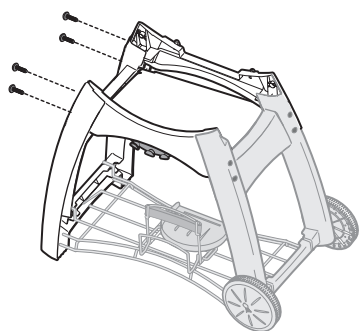

15

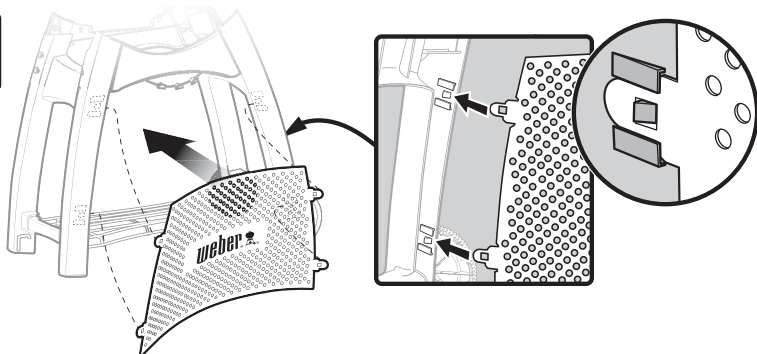

16

2-

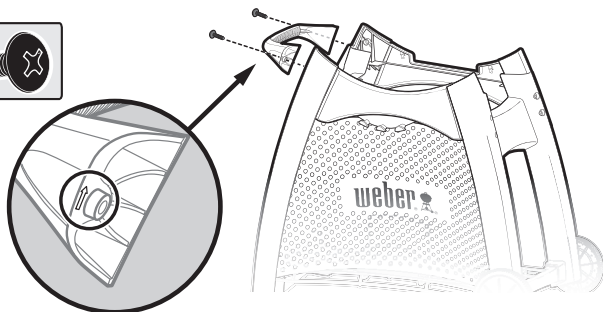

17

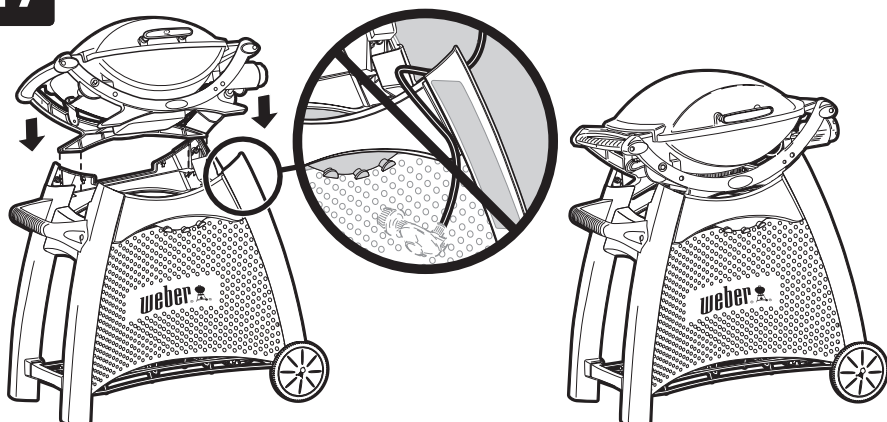

See Owner's Guide for complete gas instructions.

Prepare Grill for Cylinder Installation

Check that the burner control knob is in the off (O) position. Your grill was shipped with burner control knob in the off (O) position, but you should check to be sure that it is turned off. Check by pushing in burner control knob and turning clockwise. If it does not turn, it is off. If it does turn, continue turning the burner control knob clockwise until it stops; then it is off.

Install the LPG Cylinder

Turn the LPG cylinder so the opening of the valve is facing the right side or back of the grill.

Place the LPG cylinder on the cylinder rest (1).

Secure the cylinder to the cylinder bracket using the cylinder strap (2).

⚠ WARNING: The cylinder must be secured to the cylinder bracket when grill is in use.

⚠ WARNING: Make sure that the LPG cylinder valve is closed. Close by turning valve clockwise.

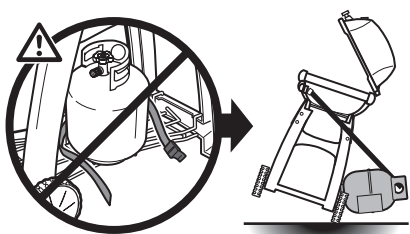
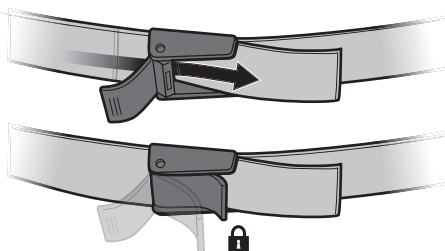
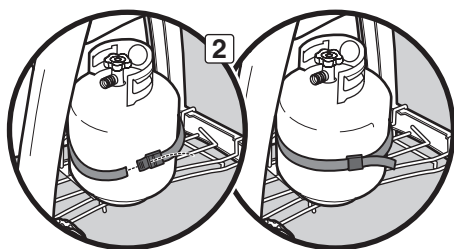
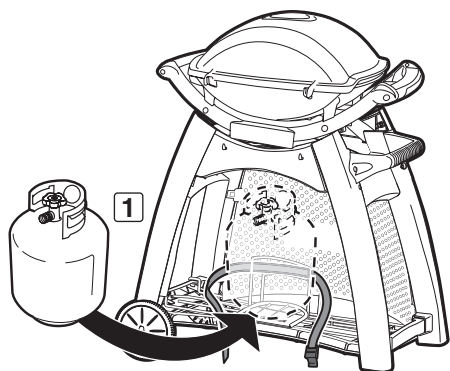

The Q® Cart® includes designs and features originally created by Robert DeMars of Original Ideas, Inc.



WEBER-STEPHEN PRODUCTS LLC

www.weber.com®

© 2013 Designed and engineered by Weber-Stephen Products LLC,
200 East Daniels Road, Palatine, Illinois 60067 U.S.A.

Printed in U.S.A.